

RELIABLE TRUSS
AND COMPONENTS, INC.
reliabletruss.com

Energy Conservation by Design

Trusses allow for simplified construction with lower waste, but they have other advantages as well. Roof trusses can be designed with raised heel heights, often called "energy heels," to allow for more insulation at the roof edge. Rather than pinching your insulation down to 4" at the wall, a simple 12" over-wall-height detail will allow you to place R-38 insulation or better over the top of the wall.

Energy Heel for R39

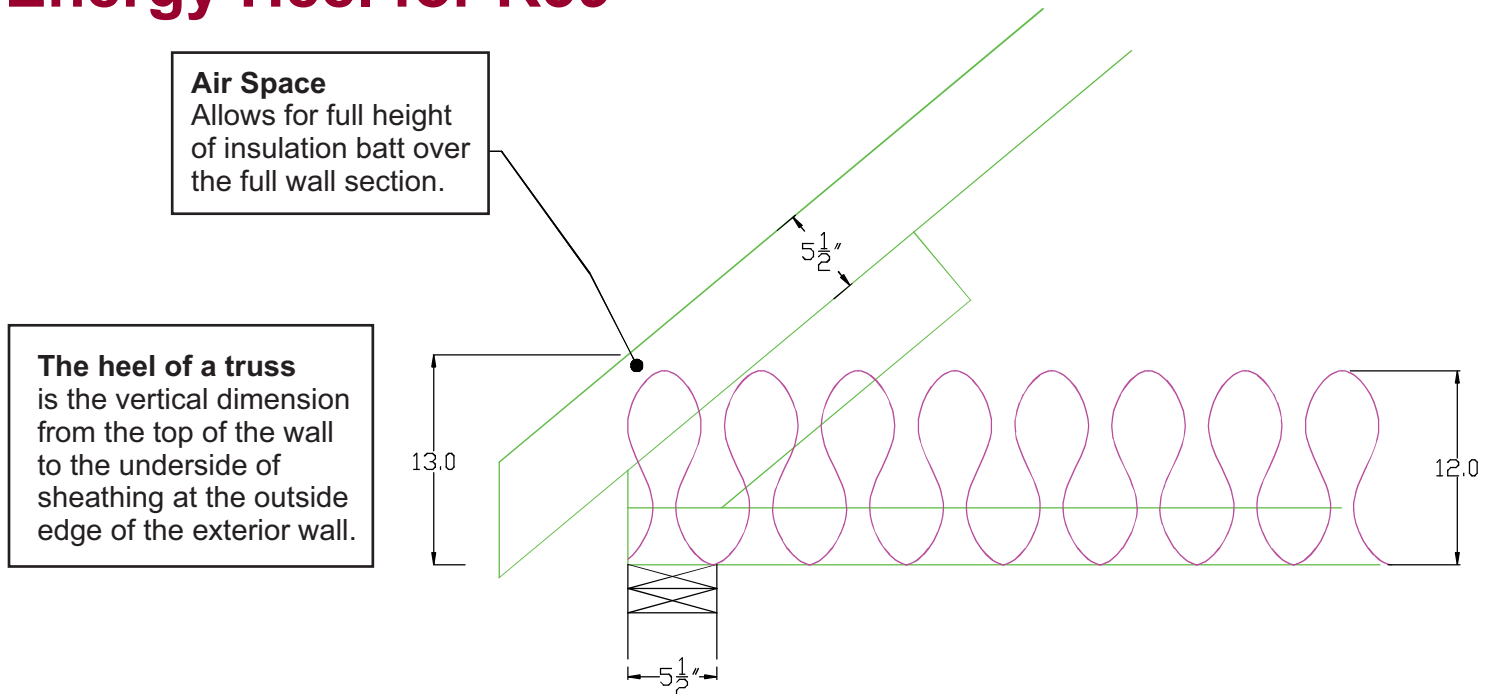

Standard Heel with 2x6 Top Chord

