



## RELIABLE TRUSS AND COMPONENTS, INC.

200 Welby Road  
New Bedford, MA

# RELIABLE HEADERS

## STRENGTH AND INSULATION

### Prefabricated Insulated Headers

- Available in full lengths or precision cut to requested lengths
- Fully adhered Expanded Polystyrene Core
- Other sizes can be purchased special order
- Header sizing can be provided for engineered headers
- Boise Cascade LVL and I-Joists used for engineered headers

### R-14 Dimensional 5-1/2" Header

Two plies of 2x SPF and 2-1/2" insulation

In Stock | No Minimum Order

MATERIAL	STOCK SIZE
(2)2x8	5-1/2" x 7-1/4" x 14'
(2)2x10	5-1/2" x 9-1/4" x 14'
(2)2x12	5-1/2" x 11-1/4" x 12'



### R-14 LVL 5-1/2" Header

Two plies of 1-1/2" LVL and 2-1/2" insulation

Standard Sizes | Minimum Order = 6

MATERIAL	STOCK SIZE
(2)1-1/2" x 9.5" LVL	5-1/2" x 9-1/2" x 16'
(2)1-1/2" x 11-7/8" LVL	5-1/2" x 11-7/8" x 16'



### R-12 LVL 5-1/2" Header

Two plies of 1-3/4" LVL and 2" insulation

Standard Sizes | Minimum Order = 6

MATERIAL	STOCK SIZE
(2)1-3/4" x 7-1/4" LVL	5-1/2" x 7-1/4" x 16'
(2)1-3/4" x 9-1/4" LVL	5-1/2" x 9-1/4" x 16'
(2)1-3/4" x 11-1/4" LVL	5-1/2" x 11-1/4" x 16'



### R-13 I-Joist Header For 2x4 Construction

3-1/2" LVL and 3" insulation

Standard Sizes | Minimum Height 11-7/8" | Minimum order = 8

MATERIAL	STOCK SIZE
(1)3-1/2" x 11-7/8" I-Joist	3-1/2" x 11-7/8" x 16'

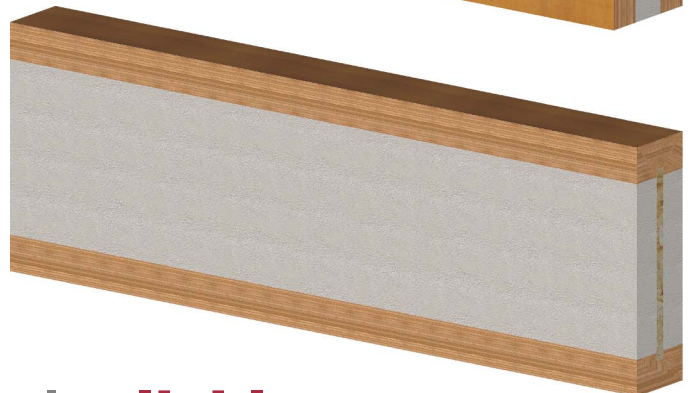

**1-888-80-TRUSS (87877) | [reliabletruss.com](http://reliabletruss.com)**